

D. D. A.

DWARKA PROJECT

AREA STATEMENT

TOTAL AREA OF THE SITE = 6236.27 sqm.

| SL.No | FACILITY | PROP AREA IN Sq.mt. Each plot | GRD COV. | F. A.R. | MAX. HT. |
|-------|-----------------------|-------------------------------|----------|---------|----------|
| 1 | PRIMARY SCHOOL | 4000.00 | 33% | 100 | 14m |
| 2 | C.S.C. incl. MB & V.B | 1486.27 | 40% | 60 | 8m |
| 3 | R. B. | 400.00 | 33.33% | 66 | 8m |
| 4 | TOT LOT | 3500.00 | | | |

THE PROPOSAL APPROVED IN 272nd SCREENING COMM. ON 8.12.08 VIDE ITEM NO. 179: 2008 AS UNDER :-
TO DELETE THE DEVELOPMENT CONTROLS MENTIONED IN THE APP. LAYOUT PLAN. THE DEVELOPMENT CONTROLS APPLICABLE WILL BE AS PER MASTER-PLAN.

DELHI DEVELOPMENT AUTHORITY
APPROVED IN 154th SCREENING COMM. MEETING HELD ON 9.05.95 ITEM NO. 54: 95 (AUTHENTICATED)
Sd/- J.C. GAMBHIR
C.A. COMM. (PLG)

- APPROVED IN THE 154th SC. COMM. MEETING HELD ON 09.05.95 VIDE ITEM NO. - 54/95.
- DIMENSIONS OF THE HAF SITE MODIFIED AS PER FEASIBILITY REPORT RECEIVED FROM EE/WD-10 DT. 9.4.96 IN FILE NO. F-8(3)94 / SEC 3/HAF/ PKT. B / DWK.

LAY OUT PLAN

HOUSING AREA FACILITIES SECTOR - 3

| | | |
|-------------------------|--|------------------------|
| 1:500 SCALE | | DWK/3pkt B/HAF/FEES |
| RUPINDER PLG. D/MAN | | DRG. NO. |
| PLG. ASST. | | FEB.-95 |
| T. SINGH ASST. DIRECTOR | | DATE |
| ANIL BARAI JT. DIRECTOR | | S. SRIVASTAVA DIRECTOR |

DELHI DEVELOPMENT AUTHORITY

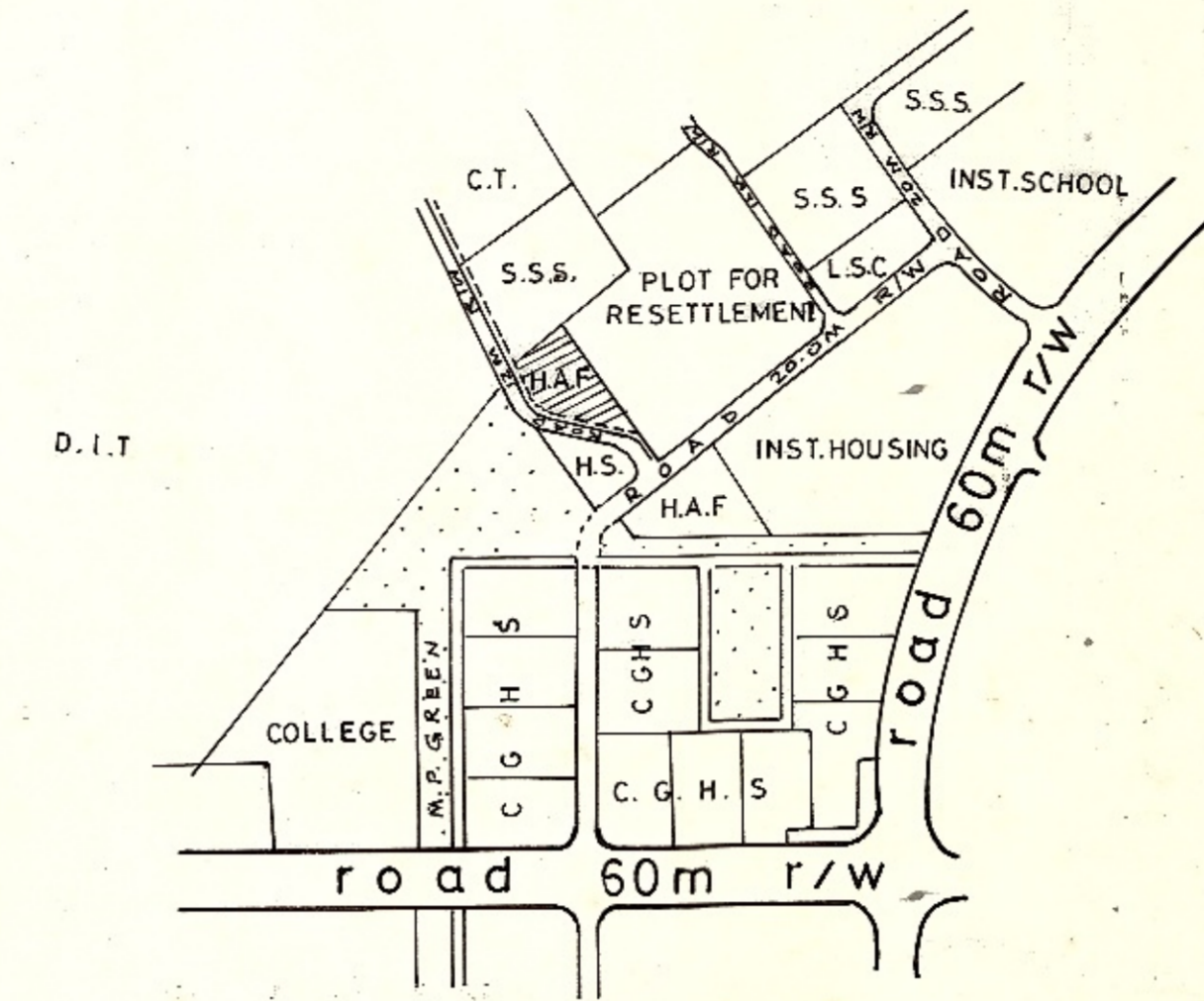

KEY PLAN
SCALE 1:8000

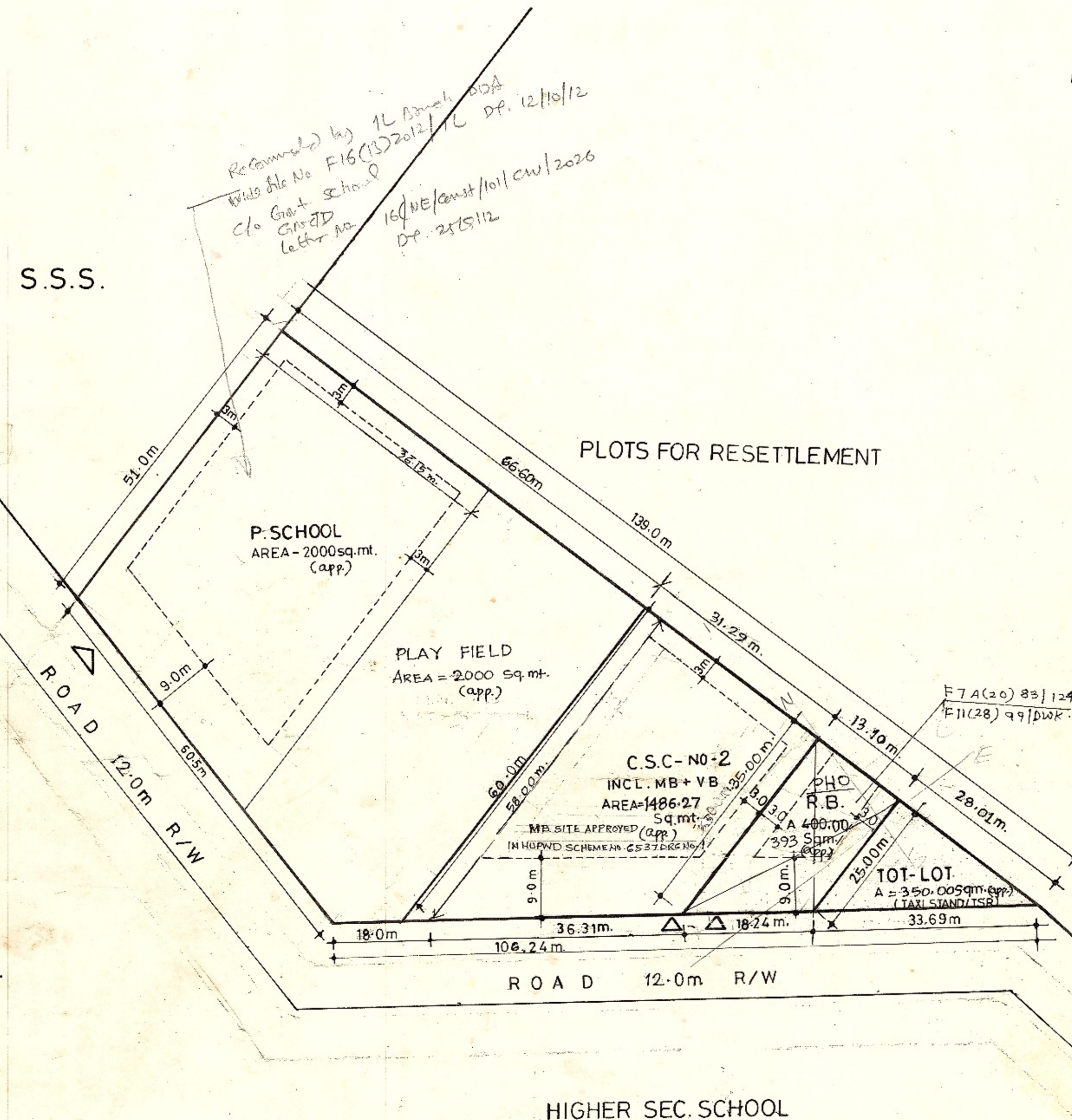

i) THE PLAN IS SUBJECT TO MODIFICATIONS WITHIN THE FRAMEWORK OF MASTER PLAN ZONAL PLAN.
ii) IT IS FOR PLANNING PURPOSE & IS NOT FIT TO BE PRODUCED IN THE COURT OF LAW FOR PROPERTY DISPUTES.
iii) ALL THE DIMENSIONS & AREA GIVEN IN THE PLAN ARE SUBJECT TO CONFIRMATION OF OWNERSHIP/ ALLOTMENT STATUS AND DEMARICATIONS/FEASIBILITY REPORT FROM DDA LANDS & ENGINEERING WING RESPECTIVELY.

Recommended by 1L Dwarka DDA
File No. F16(13)2012/1L DP. 12/10/12
C/o Grot. School
Letter No. 16/NE/cont/10/1 CW/2026
DP. 25/5/12

D.I.T.

HIGHER SEC. SCHOOL